

Fuji



FUJI TOOLS SELECTION 2021



FUJI TOOLS

Power and Precision in Perfect Harmony



**INDUSTRIAL TOOLS.
JAPANESE QUALITY
SINCE 1943**

A DEEP JAPANESE HERITAGE



From the beginning, Fuji has manufactured tools for some of the toughest and most demanding industrial environments in Japan and on the planet. This has resulted in a wide range of robust and long lasting material removal tools that is the preferred choice for metalworking in Japan and many places overseas. Our range of assembly tools and error proofing solutions was born from the needs of the Japanese manufacturing industry and delivers quality and safety together with speed of operation and ergonomic handling.

COMMITMENT TO QUALITY AND TECHNOLOGY



Every Fuji tool, from the simplest to the most sophisticated, is built to the same exacting standards. "Monozukuri", Japanese craftsmanship, is a core value in both manufacturing and design. Over 60 years of non-stop investment in R&D and kaizen manufacturing ensures that our products are built using proven, advanced technologies and provide superior ergonomics, safety and handling. Moreover, our commitment extends beyond our products to include the world we live in. Our production facilities are compliant with both the ISO 9001 and ISO 14001 standards.



**QUALITY
GUARANTEED**

**OUR COMPANY
IS CERTIFIED ISO 9001
QUALITY MANAGEMENT
AND ISO 14001
ENVIRONMENTAL
MANAGEMENT
STANDARDS.**



WIDE RANGE OF STANDARD AND SPECIAL PRODUCT

With a catalogue of over 1,400 references, we have one of the most extensive, most cost effective ranges of industrial tools available today. Our engineering team also has a long history of collaborating with customers to design solutions for special needs, both large and small.

COMMITTED TO LONG TERM CUSTOMER SATISFACTION

Fuji Tools are available through our network of authorized distributors that provide highly reactive after-sales service. They ensure that after years of service our products perform just as well as on day one. We support this network through both a dedicated international team in Japan and local market representatives in over 20 countries.

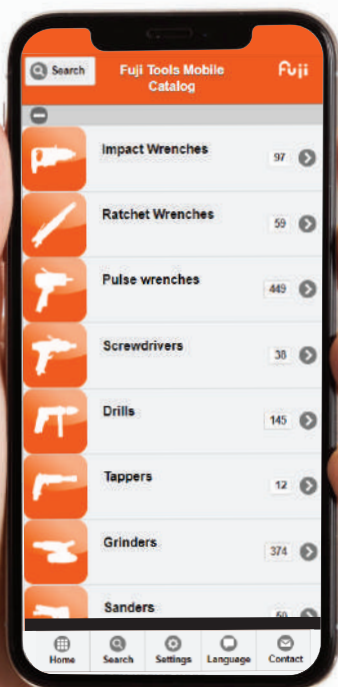
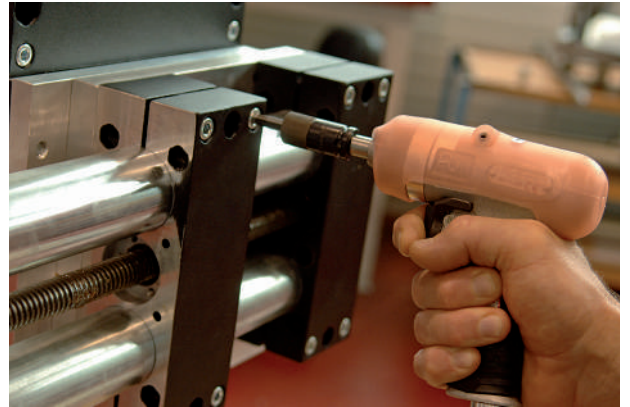

**Check out today our mobile
eCatalog on m.fujitools.com**



Need to know more?

www.fujitools.com

LinkedIn

www.linkedin.com/company/fuji-air-tools

INDEX

Grinding

- 4 - Angle Grinder ϕ 50
- 5 - FA-20 accessories
- 5 - Angle Grinder ϕ 100
- 6 - Angle Grinder ϕ 125
- 6 - Angle Grinder ϕ 180 & ϕ 230mm
- 7 - Angle Sander
- 7 - Angle Cutter
- 8 - 6mm Die Grinders
- 9 - 6mm Extended Die Grinders
- 9 - 6mm Die Grinders (Mounted wheel only)
- 10 - 3mm Pencil Grinders
- 10 - 3mm Die Grinders
- 10 - Tungsten Carbide Burrs
- 11 - Straight Grinders
- 11 - Extended Straight Grinders
- 12 - Vertical Grinders
- 12 - Orbital sander
- 12 - Belt Sanders

Percussive

- 13 - Flux Chipper
- 13 - Riveting Hammers
- 13 - Needle Scaler
- 14 - Chipping & Calking Hammers
- 14 - Sand Rammers
- 14 - Rubber Butts for FR-SERIES
- 15 - Chisels for FCH-20 series
- 15 - Chisels for FRH series
- 16 - Chisels for FC - series

Drills and Tappers

- 17 - Drills
- 18 - Corners Drills
- 18 - Baby Angle Drills
- 19 - Heavy Duty Drills
- 19 - Tappers

Assembly

- 20 - Impacts wrenches
- 21 - Pulse wrenches non-shut off
- 21 - Pulse wrenches shut off

Special Tools

- 22 - Pipe Beveling
- 22 - Air saw
- 22 - Saw Blades for FRS-45
- 23 - Milling machine

Air Motors

- 24 - Air motor - Reversible Type
- 25 - Air motor - Non-reversible Type
- 25 - Air line accessories

GRINDING



ANGLE GRINDER Ø50

FA-20 series

ULTRA COMPACT ANGLE GRINDER

- Low profile head, compact, powerful for easy access
- Easy to handle
- Low vibration for long time work



FA-20X-1



FA-20-1F



FA-20X-1F

Model	Part number	Exhaust	Throttle	Wheel size	Free speed	Power	Head Height	Overall Length	Weight	Air consumption	Inlet	Hose inner diameter
				mm	rpm	w	mm	mm	kg	m ³ /min	Inch	mm
FA-20-1	5412104835	Side	Roll	50X4X9.53	15,000	294	40.5	157	0.6	0.59	Rc 1/4	9.5
FA-20-1F	5412104836	Side	Safety lever	50X4X9.53	15,000	283	40.5	186	0.7	0.56	Rc 1/4	9.5
FA-20X-1	5412104841	Rear	Roll	50X4X9.53	15,000	266	40.5	191	0.8	0.51	Rc 1/4	9.5
FA-20X-1F	5412104842	Rear	Safety lever	50X4X9.53	15,000	265	40.5	220	0.8	0.54	Rc 1/4	9.5

"Different versions available, please check our catalogue or contact Fuji on fujitools.com"

FA-20 accessories

Rubber Pad

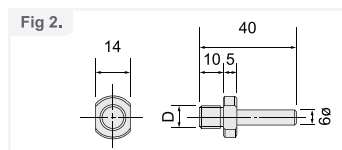

Part number	Size
541 205 0654	W3/8 -16

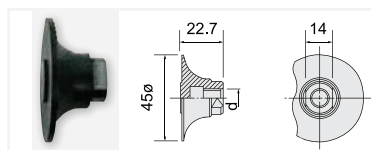

Adhesive Type	
Part number	Size
541 205 5541	W3/8 -16

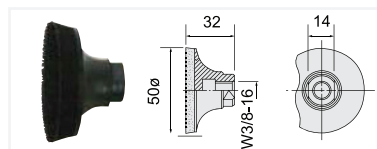

VELCRO WITH SPONGE TYPE

Part number
541 205 4844

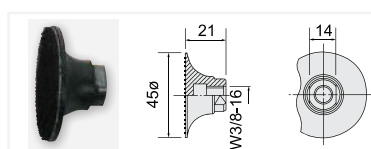

Velcro type

Part number
541 205 4843

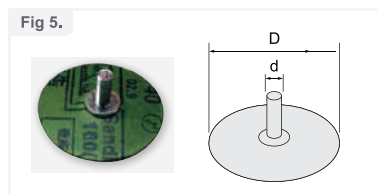

SHAFT TYPE

Part number	Size		Grit #
	D	D	
	mm	mm	
541 205 4837	50	1/4-28 UNF	40
541 205 4838			60
541 205 4839			80
541 205 4840			100

Sold by 50 pieces

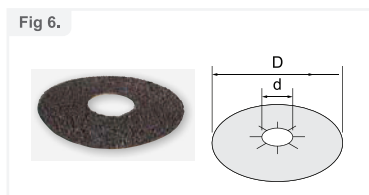

Adhesive Type

Part number	Size		Grit #
	D	D	
	mm	mm	
541 205 2015	50	16	40
541 205 2016			60
541 205 2017			80
541 205 2018			100
541 205 2019			120
541 205 2020			150
541 207 0827			180
541 205 2021			240
541 207 0828			320
541 207 0826			400

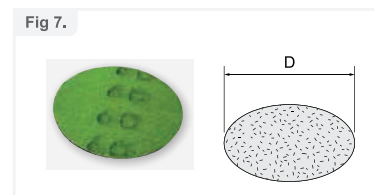

Velcro Type

Part number	Size	Grit #
	D	
	mm	
541 207 4556	50	40
541 205 4845		60
541 207 4557		80
541 205 4846		100
541 207 4558		120
541 205 4847		150
541 207 4559		240
541 205 4848		320

"Different versions available, please check our catalogue or contact Fuji on fujitools.com"

ANGLE GRINDER Ø100



FA-30 Ultra compact



FA-4C Versatile



FA-40 Productivity

Model	Part number	Throttle	Wheel size	Free speed	Power	Head Height	Overall Length	Weight	Air consumption	Inlet	Hose inner diameter
			mm	rpm	w	mm	mm	kg	m ³ /min	Inch	mm
FA-30-3 5/8	5412105272	Roll	100X6X15.8	13,500	490	57	182	1.05	0.68	Rc 1/4	9.5
FA-30-3F	5412105151	Safety lever	100X6X15	13,500	482	57	202	1.1	0.65	Rc 1/4	9.5
FA-4C-1 5/8	5412052301	Roll	100X6X15.8	13,500	550	77	210	1.8	0.55	Rc 3/8	9.5
FA-4-1 5/8	5412071119	Roll	100X6X15.8	13,500	1,000	76	208	1.9	1.0	Rc 3/8	9.5

"Different versions available, please check our catalogue or contact Fuji on fujitools.com"

ANGLE GRINDER Ø 125

FA-65 series

FOR EXTREME WORK

- 1500W for heavy metal industry
- Up to 1000 hours maintenance interval



FA-65-1



FA-65-2F



FA-45-1



FA-45-12F

Model	Part number	Throttle	Wheel size	Free speed	Power	Head Height	Overall Length	Weight	Air consumption	Inlet	Hose inner diameter
			mm	rpm	w	mm	mm	kg	m ³ /min	Inch	mm
FA-65-1	5412106151	Roll	125X6X22	10,900	1,500	74	208	2.0	1.3	Rc 3/8	12.7
FA-65-2F N EC	5412106152	Safety lever	125X6X22.2	12,000	1,400	74	259	2.1	1.3	NPT 3/8	12.7
FA-45-1	5412104874	Roll	125X6X22	10,900	1,100	66.4	208	2.00	1.09	Rc 3/8	12.7
FA-45-12F N EC	5412105555	Safety Lever	125X6X22.2	12,000	1,000	66.4	259	2.0	1.09	NPT 3/8	12.7

"Different versions available, please check our catalogue or contact Fuji on fujitools.com"

ANGLE GRINDER Ø 180 & 230

FA-67 series

BEST RATIO WEIGHT POWER

- Compact: One of the most compact 7-inch grinder delivering more than 2Hp
- Industry proof: improved bevel gear and motor for extended lifetime



FA-67



FA-70-2 2.4 Hp



FA-9C-2 230mm

Model	Part number	Throttle	Wheel size	Free speed	Power	Head Height	Overall Length	Weight	Air consumption	Inlet	Hose inner diameter
			mm	rpm	w	mm	mm	kg	m ³ /min	Inch	mm
FA-67-1	5412106204	Roll	180X6X22	7,600	1,600	72	229	2.5	1.4	Rc 3/8	12.7
FA-67-8F	5412106205	Safety lever	180X6X22.2	7,600	1,500	72	280	2.9	1.4	NPT 3/8"	12.7
FA-70-2	5412104530	Roll	180X6X22.2	7,600	1,800	89	275	3.3	175	Rc 3/8	12.7
FA-9C-2	5412052382	Roll	230X9.5X22.2	5,900	1,620	95	309	4.4	1.65	RC 1/2	12.7

"Different versions available, please check our catalogue or contact Fuji on fujitools.com"

Angle Sander



FA-150K-20



FA-150KG-30



FA-3CK-1



FA-70 + Pad



FA-45-11



FV-7-2M

Model	Part number	Type	Pad or Brush Size	Free speed	Power	Overall Length	Weight	Air consumption	Inlet	Hose inner diameter
			mm	rpm	w	mm	kg	m ³ /min	Inch	mm
FA-3CK-1	5412052289	Sander	76X16	11,000	290	164	1.1	0.4	Rc 1/4	9.5
FA-150K-20 SD	5412071068	Sander	127X22.2	8,400	900	210	1.7	1.0	Rc 3/8	12.7
FA-150K-20 BR	5412071070	Brush	-	8,400	900	210	1.7	1.0	Rc 3/8	12.7
FA-150K-30 SD	5412071072	Sander	127X22.2	8,400	900	210	1.9	1.1	Rc 3/8	12.7
FA-150K-30 BR	5412071073	Brush	-	8,400	900	210	1.9	1.1	Rc 3/8	12.7
FA-45-11	5412104965	Sander	127X22.2	7,000	870	208	1.9	0.82	Rc 3/8	12.7
FA-70-1 + PAD	5412104529 + 5412055550	Sander	180X22	7,000	1800	275	3.3	0.46	Rc 1/2	12.7
FV-7-2M SD	5412053519	Sander	180X22	7,000	1,580	247	4	1.6	Rc 1/2	12.7

"Different versions available, please check our catalogue or contact Fuji on fujitools.com"

Angle Cutter



FA-30-23 Mini Cutter



FA-45-8



FA-67-21



FA-67-23

Model	Part number	Disc type	Wheel size	Free speed	Power	Height	Length	Weight	Air consumption	Inlet	Hose inner diameter
			mm	rpm	w	mm	mm	kg	m ³ /min	Inch	mm
FA-30-23	5412106289	Abrasive	105X3X15	13,500	490	57	189	1.86	0.6	Rc 1/4	9.5
FA-45-8	5412104964	Diamond	125X2X20	10,900	1,100	66.4	208	2	1.1	Rc 3/8	9.5
FA-67-21	5412106208	Diamond	180X2X25.4	7,600	1,600	72	229	2.5	1.4	Rc 3/8	12
FA-67-23	5412106209	Abrasive	180X3X22	7,600	1,600	72	229	2.5	1.4	Rc 3/8	12

"Different versions available, please check our catalogue or contact Fuji on fujitools.com"

6mm Die Grinders

Roll throttle



FG-26H-20



FG-50H-2

Model	Part number	Collet Size	Free speed	Power	Overall Length	Tool Diameter	Weight	Air consumption	Inlet	Hose inner diameter
		mm	rpm	w	mm	mm	kg	m ³ /min	Inch	mm
Front Exhaust										
FG-26H-20 6 FE	5412105857	6	24,000	315	170	13	0.61	0.59	Rc 1/4	9.5
FG-50H-2 6 FE	5412103203	6	18,000	340	176	22	0.8	0.6	Rc 1/4	9.5
Side Exhaust										
FG-26H-20 6	5412105856	6	24,000	315	170	13	0.61	0.59	Rc 1/4	9.5
FG-50H-2 6	5412103202	6	18,000	340	176	22	0.8	0.6	Rc 1/4	9.5

"Different versions available, please check our catalogue or contact Fuji on fujitools.com"

Lever throttle



FG-26H-10



FG-50H-1

Model	Part number	Collet Size	Free speed	Power	Length	Tool Diameter	Weight	Air consumption	Inlet	Hose inner diameter
		mm	rpm	w	mm	mm	kg	m ³ /min	Inch	mm
Front Exhaust										
FG-26H-10 6 FE	5412105866	6	24,000	275	179	13	0.52	0.59	Rc 1/4	9.5
FG-50H-1 6 FE	5412103212	6	18,000	340	187	22	0.7	0.6	Rc 1/4	9.5
Side Exhaust										
FG-26H-10 6	5412105865	6	24,000	275	179	13	0.52	0.59	Rc 1/4	9.5
FG-50H-1 6	5412103211	6	18,000	340	187	22	0.7	0.6	Rc 1/4	9.5

"Different versions available, please check our catalogue or contact Fuji on fujitools.com"

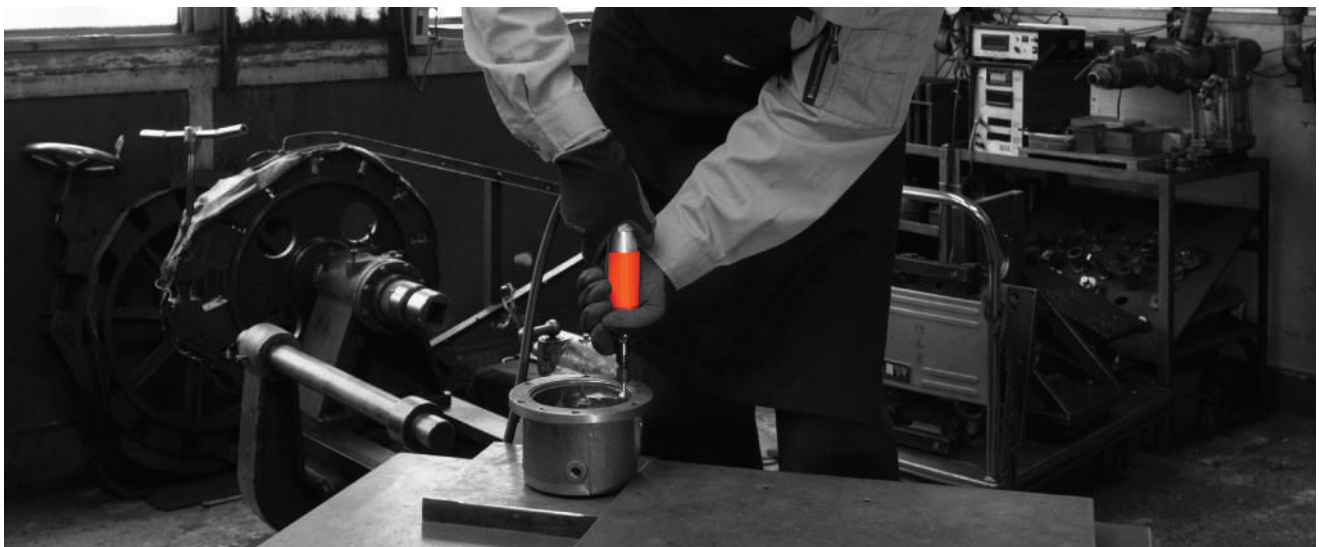

6mm Extended Die Grinders

Roll throttle model

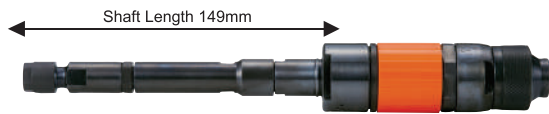

FG-26HL-20

Lever throttle model



FG-26HL-10F

Model	Part number	Collet Size	Free speed	Power	Length	Tool Diameter	Weight	Inlet	Hose inner diameter
		mm	rpm	w	mm	mm	kg	Inch	mm
Front Exhaust									
FG-26HL-20 6 FE	5412105959	6	24,000	290	263	13	0.74	Rc 1/4	9.5
FG-26HL-10F 6 FE	5412105953	6	24,000	280	272	13	0.65	Rc 1/4	9.5
Side Exhaust									
FG-26HL-20 6	5412105957	6	24,000	290	263	13	0.74	Rc 1/4	9.5
FG-26HL-10F 6	5412105951	6	24,000	280	272	13	0.65	Rc 1/4	9.5

"Different versions available, please check our catalogue or contact Fuji on fujitools.com"



6mm Die Grinders (Mounted wheel only)



FG-3HA-10

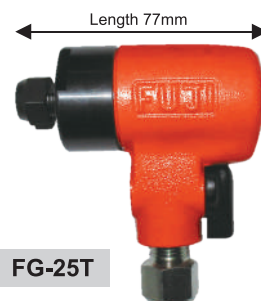

FG-25T

Model	Part number	Exhaust	Collet Size	Free speed	Overall Length	Tool Diameter	Weight	Air consumption	Inlet	Hose inner diameter
			mm	rpm	mm	mm	kg	m ³ /min	Inch	mm
FG-3HA-10	5412103175	Side	6	14,000	520	48	1.3	0.8	Rc 3/8	9.5
FG-3H-5 6 E	5412052828	Side	6	14,600	342	48	1.3	0.55	Rc 3/8	9.5
FG-25T	5412071446	Side	6	20,000	220	77	0.37	0.25	Rc 1/4	9.5

"Different versions available, please check our catalogue or contact Fuji on fujitools.com"

3mm Pencil Grinders

High-precision, high-speed (60,000 rpm) pencil type.



FG-06-1



FG-06S-1



Model	Part number	Collet Size	Free speed	Power	Overall Length	Weight	Air consumption	Inlet	Hose inner diameter
		mm	rpm	w	mm	kg	m ³ /min	Inch	mm
FG-06-1 3	5412052686	3	60,000	90	153	0.15	0.17	Rc 1/4	4
FG-06S-1 3	5412078461	3	60,000	90	166	0.13	0.17	Rc 1/4	4

"Different versions available, please check our catalogue or contact Fuji on fujitools.com"

3mm Die Grinders

Roll throttle model



FG-13-2



FG-13-20

Protected cover for rough work



FG-13-1

Short cover for narrow space grinding



FG-13-10

Model	Part number	Exhaust	Collet Size	Free speed	Power	Overall Length	Weight	Air consumption	Inlet	Hose inner diameter
			mm	rpm	w	mm	kg	m ³ /min	Inch	mm
FG-13-2 3	5412052727	Front	3	30,000	140	150	0.5	0.25	Rc 1/4	6.3
FG-13-20 3	5412052730	Front	3	30,000	140	150	0.5	0.25	Rc 1/4	6.3
FG-13-1 3	5412052712	Front	3	30,000	140	158	0.37	0.25	Rc 1/4	6.3
FG-13-10 3	5412052721	Front	3	30,000	140	158	0.37	0.25	Rc 1/4	6.3

"Different versions available, please check our catalogue or contact Fuji on fujitools.com"

TUNGSTEN CARBIDE BURRS

3mm Shank Dia

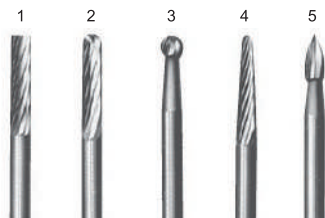

6mm Shank Dia



Index	Model	Part number	Size (mm)		Model
			Head	Length	
1	A03	5412060314	3	38	FG-13 Series, FG-06, FG-06S
2	B03	5412060315	3	38	
3	C03	5412060316	3	38	
4	E03	5412060317	3	38	
5	F03	5412060318	3	38	

Index	Model	Part number	Size (mm)		Model
			Head	Length	
6	A08	5412060325	8	55	FG-26g Series, FG-50 Series
7	C08	5412060327	8	55	
8	E08	5412060328	8	55	
9	F08	5412060329	8	55	
10	H08	5412060330	8	55	

"Different versions available, please check our catalogue or contact Fuji on fujitools.com"

Straight Grinders



Model	Part number	Exhaust	Wheel dimension	Free speed	Power	Overall Length	Weight	Air consumption	Inlet	Hose inner diameter
			mm	rpm	w	mm	kg	m ³ /min	Inch	mm
FG-3H-1	5412052818	Side	65×13×9.53	14,600	520	317	1.5	0.55	Rc 3/8	9.5
FG-3H-2	5412052823	Side	75×13×9.53	12,700	520	317	1.5	0.55	Rc 3/8	9.5
FG-4H-1	5412052849	Side	100×19×9.53	9,500	690	385	2.2	0.8	Rc 3/8	12.7
FG-4H-2	5412052853	Side	100×19×12.7	9,500	690	391	2.2	0.8	Rc 3/8	12.7
FG-5H-1 E	5412052864	Side	125×19×12.7	7,600	960	405	2.7	1.0	Rc 3/8	12.7
FG-5H-2	5412052868	Side	125×19×15.8	7,600	960	410	2.8	1.0	Rc 3/8	12.7
FG-5H-3	5412071604	Side	150×25×15.8	6,300	960	421	2.8	0.9	Rc 3/8	12.7
FG-6H-1 E	5412052941	Side	150×25×15.8	6,300	1040	434	3.5	1.2	Rc 3/8	12.7

"Different versions available, please check our catalogue or contact Fuji on fujitools.com"

Extended Straight Grinders

The long shaft makes it ideal for grinding deep holes and narrow spaces

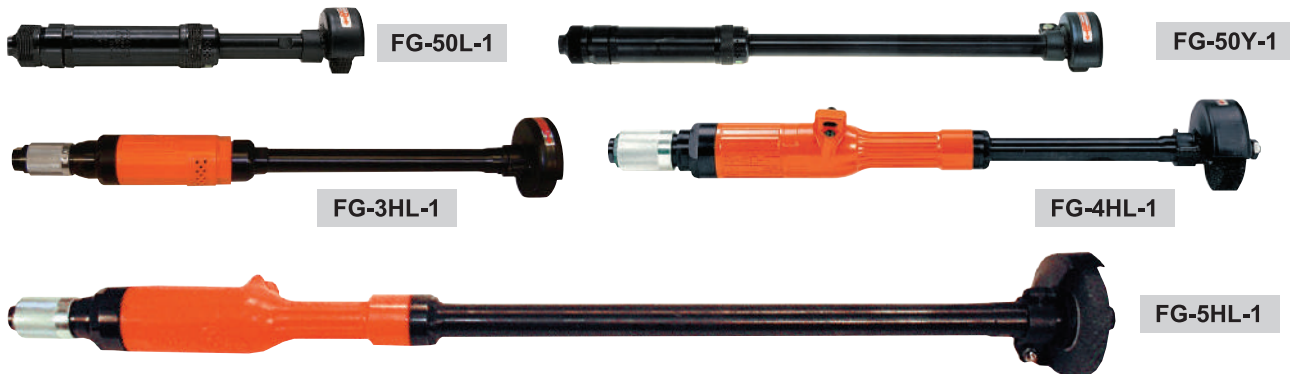

Model	Part number	Exhaust	Wheel dimension	Free speed	Power	Overall Length	Weight	Air consumption	Inlet	Hose inner diameter
			mm	rpm	w	mm	kg	m ³ /min	Inch	mm
FG-50L-1 E	5412052924	Side	50×13×9.53	18,000	294	307	1.4	0.43	Rc 1/4	9.5
FG-50Y-1 E	5412052937	Side	50×13×9.53	18,000	294	523	2.0	0.43	Rc 1/4	9.5
FG-3HL-1	5412052834	Side	65×13×9.53	12,000	520	522	1.9	0.55	Rc 3/8	9.5
FG-3HY-1	5412052838	Side	65×13×9.53	12,000	520	702	2.3	0.55	Rc 3/8	9.5
FG-4HL-1	5412052857	Side	75×19×9.53	12,000	690	585	2.7	0.8	Rc 3/8	12.7
FG-5HL-1	5412052872	Side	75×19×12.7	12,000	960	953	5.3	1.0	Rc 3/8	12.7
FG-5HL-2	5412052874	Side	100×19×12.7	9,000	960	953	5.3	1.0	Rc 3/8	12.7
FG-5HL-11	5412071605	Side	75×19×9.53	12,000	960	599	3.3	1.0	Rc 3/8	12.7
FG-5HL-13	5412071607	Side	100×16×12.7	9,000	960	599	3.3	1.0	Rc 3/8	12.7

"Different versions available, please check our catalogue or contact Fuji on fujitools.com"

Vertical Grinders



FV-7-4M



FV-9-1M



FV-9BH-4M

Model	Part number	Exhaust	Dimension	Free speed	Power	Overall Length	Weight	Air consumption	Inlet	Hose inner diameter
			mm	rpm	w	mm	kg	m ³ /min	Inch	mm
FV-7-4M E	5412053523	Side	180×6×22.2	8,400	1,770	247	4	1.7	Rc 3/8	9.5
FV-9BH-1M E	5412053526	Side	230×8×22.2	5,900	3,320	279	5.8	2.8	Rc 1/2	12.5
FV-9BH-4M	5412053529	Side	150×50×22.2	4,500	2,900	279	6.1	2.4	Rc 1/2	12.5

"Different versions available, please check our catalogue or contact Fuji on fujitools.com"

Orbital sander



FOR-50

Model	Part number	Type	Pad Type	Pad diam.	Speed	Power	Overall Length	Weight	Air consumption	Inlet	Hose inner diameter
				mm	rpm	w	mm	kg	m ³ /min	Inch	mm
FOR-50ANV-E	5412106329	Non vacuum	Adhesive	125	12,000	280	150	0.71	0.4	Rc 1/4	9.5
FOR-50ANV-M	5412106330	Non vacuum	Velcro	125	10,000	280	150	0.71	0.4	Rc 1/4	9.5
FOR-50ACV-E	5412106331	Central vacuum	Adhesive	125	10,000	280	150	0.76	0.4	Rc 1/4	9.5
FOR-50ACV-M	5412106332	Central vacuum	Velcro	125	10,000	280	150	0.76	0.4	Rc 1/4	9.5

"Different versions available, please check our catalogue or contact Fuji on fujitools.com"

Belt Sanders



FBS-1-1&3



FBS-1-2&4

Model	Part number	Belt size	Free speed	Power	Overall Length	Weight	Air consumption	Inlet	Hose inner diameter
		mm	rpm	w	mm	kg	m ³ /min	Inch	mm
FBS-1-1	5412052463	10 x 330	1,200	280	281	1.1	0.57	Rc 1/4	9.5
FBS-1-2	5412052465	20 x 520	8,400	280	375	1.2	0.57	Rc 1/4	9.5
FBS-1-3	5412052467	13 x 460	8,400	280	345	1.2	0.57	Rc 1/4	9.5
FBS-1-4 E	5412052470	20 x 460	5,500	280	345	1.2	0.57	Rc 1/4	9.5

"Different versions available, please check our catalogue or contact Fuji on fujitools.com"

PERCUSSIVE

Flux Chipper



FCH-20



FCH-25



FCH-20F



FCH-25B

Model	Part number	Chisel Shank (mm)	Blow BPM	Piston diameter	Stroke	Overall Length	Weight	Air consumption	Inlet	Hose inner diameter
				mm	mm	mm	kg	m ³ /min	Inch	mm
FCH-20 E	5412052552	11	5,400	20	16	176	0.8	0.14	Rc 1/4	6.3
FCH-20F E	5412052557	12	5,400	20	16	182	1.0	0.14	Rc 1/4	9.5
FCH-25 E	5412052562	12	3,600	25	20	204	1.5	0.18	Rc 1/4	9.5
FCH-25B E	5412052566	12	3,600	25	20	239	1.7	0.18	Rc 1/4	9.5

"Different versions available, please check our catalogue or contact Fuji on fujitools.com"

Riveting Hammers



FRH-3



FRH-6



FRH-6A

Model	Part number	Chisel Shank	Riveting Capacity (mm)		Blow BPM	Piston diameter	Stroke	Overall Length	Weight	Air consumption	Inlet	Hose inner diameter
			Duralmin	Steel	BPM	mm	mm	mm	kg	m ³ /min	Inch	mm
FRH-3-1 E	5412053381	Hex.	3.2	2.5	3,600	14.3	38	140	1.1	0.35	Rc 1/4	9.5
FRH-3-2 E	5412072250	Round	3.2	2.5	3,600	14.3	38	140	1.1	0.35	Rc 1/4	9.5
FRH-6-1 E	5412053389	Hex.	6.4	5.0	1,800	12.7	100	206	1.4	0.35	Rc 1/4	9.5
FRH-6-2 E	5412053393	Round	6.4	5.0	1,800	12.7	100	206	1.4	0.35	Rc 1/4	9.5
FRH-6A-1 E	5412103186	Hex.	6.4	5.0	3,000	20.7	44.5	193	1.5	0.4	Rc 1/4	9.5
FRH-6A-2 E	5412053401	Round	6.4	5.0	3,000	20.7	44.5	193	1.5	0.4	Rc 1/4	9.5

"Different versions available, please check our catalogue or contact Fuji on fujitools.com"

Needle Scaler

FNS-2



FNS-2P



Model	Part number	Throttle	Blow BPM	Piston	Stroke	Needle length	Needle diameter	Number of needles	Overall Length	Weight	Air consumption	Vibration	Inlet	Hose inner diameter
				mm	mm	mm	mm	Pcs	mm	kg	m ³ /min	m/s ²	Inch	mm
FNS-2 3 E	5412053047	Lever	8,000	25.0	7	180	3	19	325	1.9	0.18	8.0	Rc 1/4	9.5
FNS-2 2	5412071942	Lever	8,000	25.0	7	180	2	37	325	1.9	0.18	8.0	Rc 1/4	9.5
FNS-2P 3 E	5412053055	Lever	8,000	25.0	7	180	3	19	371	2.5	0.18	7.4	Rc 1/4	9.5
FNS-2P 2	5412071949	Lever	8,000	25.0	7	180	2	37	371	2.5	0.18	7.4	Rc 1/4	9.5

"Different versions available, please check our catalogue or contact Fuji on fujitools.com"

Chipping & Calking Hammers



FC-01SA



FC-01



FC-1Z~4Z

Model	Part number	Chisel Shank	Blows	Piston diameter	Stroke	Chisel Insert	Overall Length	Weight	Air consumption	Inlet	Hose inner diameter
			Bpm	mm	mm	mm	mm	kg	m ³ /min	Inch	mm
FC-01SA-H	5412052476	Hex.	3,000	20.0	44.5	12X45	273	2.5	0.42	Rc 1/4	9.5
FC-01SA-R	5412052478	Round	3,000	20.0	44.5	14X45	273	2.5	0.42	Rc 1/4	9.5
FC-01-3	5412052471	Hex.	3,000	20.0	44.5	12X45	273	2.6	0.42	Rc 1/4	9.5
FC-01-4	5412052474	Round	3,000	20.0	44.5	14X45	273	2.6	0.42	Rc 1/4	9.5
FC-1Z-1	5412052480	Hex.	3,000	28.5	25	14.8X60	301	5.0	0.6	Rc 3/8	12.7
FC-1Z-2	5412052482	Round	3,000	28.5	25	17.5X60	301	5.0	0.6	Rc 3/8	12.7
FC-2Z-1	5412052484	Hex.	2,520	28.5	51	14.8X60	342	5.7	0.6	Rc 3/8	12.7
FC-2Z-2	5412052486	Round	2,520	28.5	51	17.5X60	342	5.7	0.6	Rc 3/8	12.7
FC-3Z-1	5412052488	Hex.	2,280	28.5	76	14.8X60	386	6.3	0.65	Rc 3/8	12.7
FC-3Z-2	5412052490	Round	2,280	28.5	76	17.5X60	386	6.3	0.65	Rc 3/8	12.7
FC-4Z-1	5412052492	Hex.	1,680	28.5	102	14.8X60	425	6.8	0.65	Rc 3/8	12.7
FC-4Z-2	5412052494	Round	1,680	28.5	102	17.5X60	425	6.8	0.65	Rc 3/8	12.7

"Different versions available, please check our catalogue or contact Fuji on fujitools.com"

Sand Rammers



FR-18B~25B



FR-18L~32 Extended

Model	Part number	Blows	Piston diameter	Stroke	Butt diameter	Overall length (Max)	Weight	Air consumption	Inlet	Hose inner diameter
		Bpm	mm	mm	mm	mm	kg	m ³ /min	Inch	mm
FR-18B E	5412053216	1,800	18.0	50.0	41	280 (358)	1.5	0.4	Rc 1/4	9.5
FR-22B	5412053225	1,000	22.0	64.0	51	350 (455)	3.0	0.5	Rc 3/8	9.5
FR-25B	5412053233	800	25.4	83.0	67	539 (622)	5.5	0.7	Rc 3/8	12.7
FR-18L E	5412053221	1,800	18.0	50.0	41	547 (625)	2.0	0.4	Rc 1/4	9.5
FR-22L	5412053229	1,000	22.0	64.0	51	621 (726)	3.3	0.5	Rc 1/4	9.5
FR-25L	5412053237	800	25.4	83.0	67	1,043 (1,191)	6.0	0.7	Rc 1/2	12.7
FR-32	5412053241	700	32.0	127.0	75	1,086 (1,255)	10.0	0.8	Rc 1/2	12.7

"Different versions available, please check our catalogue or contact Fuji on fujitools.com"

Rubber Butts for FR-SERIES



Type	Part number	Size			Model
		D	d	H	
		mm	mm	mm	
R-1	541 205 5532	51	11.8	60	FR-18B, 18L
R-1-1	541 205 5533	41	12.7	47	FR-18B, 18L
R-2	541 205 5534	51	13.75	60	FR-22B, 22L
R-3	541 205 5535	67	17.25	80	FR-25B, 25L
R-4	541 205 5536	75	18.75	92	FR-32

"Different versions available, please check our catalogue or contact Fuji on fujitools.com"

CHISELS FOR FCH-20 series

For FCH-20

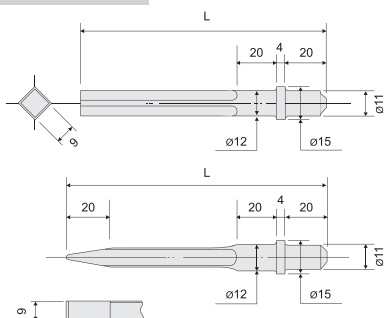

Model	Cutting Edge Shape	Size
		L mm
541 205 3807	Square	125
541 205 3808		155
541 205 3809		200
541 205 3810		250
541 205 2605		300
541 205 4197	Flat	130
541 207 4198		155
541 205 4199		200
541 207 4200		250
541 207 2795		300

Different versions available, please check our catalogue or contact Fuji on fujitools.com

For FCH-20F, 25

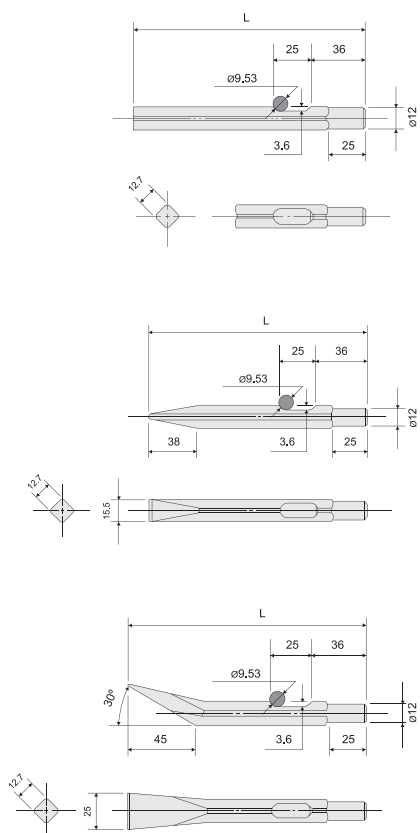

Model	Cutting Edge Shape	Size
		L mm
541 205 2046	Square	140
541 205 2047		155
541 205 2048		200
541 205 2049		250
541 205 2050		300

Model	Cutting Edge Shape	Size
		L mm
541 205 2080	Flat	155
541 205 2081		200
541 205 2082		250
541 205 2083		300
541 205 1017		400

Model	Cutting Edge Shape	Size
		L mm
541 205 2096	Flat Bended	155
541 205 2097		200
541 205 2098		250
541 205 2099		300
541 205 1026		400

CHISELS FOR FRH series

Round

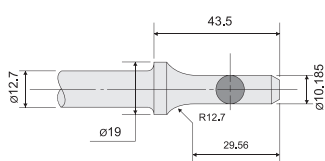

808

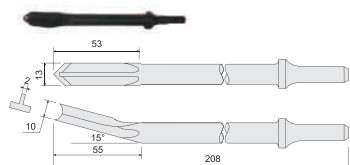

812

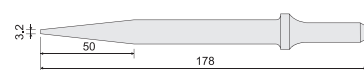

814



Hex

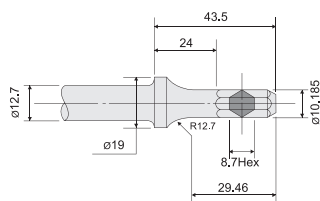

809

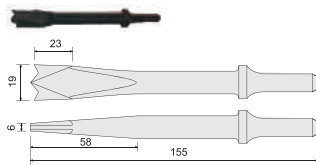

813

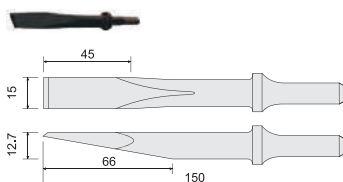

No.	Model		Description
	Round	Hex.	
808	541 205 8692	541 205 8693	Muffler Cutter
809	541 205 8694	541 205 8695	Double Edge Panel Cutter
810	541 205 8696	541 205 8697	Flat Chisel
812	541 205 8698	541 205 8699	Taper Punch
813	541 205 8700	541 205 8701	Rivet Cutter
814	541 205 8702	541 205 8703	Blank Chisel
815	541 205 8704	541 205 8705	Spot Weld Breaker

Different versions available, please check our catalogue or contact Fuji on fujitools.com

810

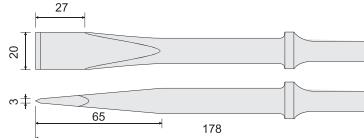

815

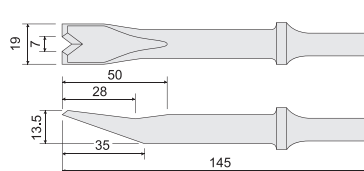

CHISELS FOR FC - series

CHISELS SHANK SIZE

For FC-01, FC-01SA

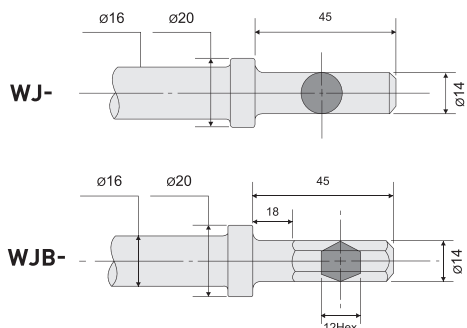

For FC-1Z~4Z

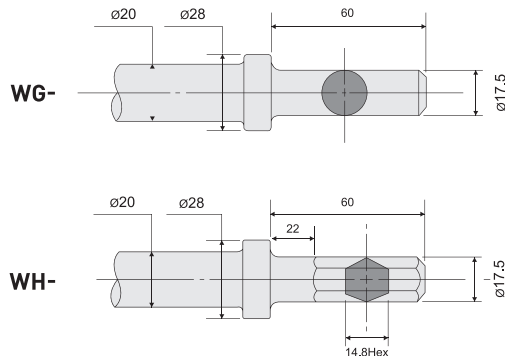

SHAPES OF CHISELS END

BLANK CHISELS



Model	Size	Chisel Shank	Model
	L		
541 205 8740	200	Round	FC-01-4, FC-01SA
541 205 8737	250		
541 205 8738	300		
541 205 8739	400		
541 205 8750	200	Hex	FC-01-3, FC-01SA
541 205 8744	250		
541 205 8748	300		
541 205 8749	400		
541 205 8708	250	Round	FC-1Z-2~, FC-4Z-2
541 205 8712	300		
541 205 8717	250	Hex	FC-1Z-1~, FC-4Z-1
541 205 8721	300		

FLAT CHISELS



16mm (FC-01) 20mm (FC-*Z)

Model	Size	Chisel Shank	Model
	L		
541 205 8741	200	Round	FC-01-4, FC-01SA
541 205 8751	200	Hex	FC-01-3, FC-01SA
541 205 8745	250		
541 205 8714	200	Round	FC-1Z-2, FC-4Z-2
541 205 8709	250		
541 205 8727	200	Hex	FC-1Z-1, FC-4Z-1
541 205 8718	250		

POINT CHISELS (P)

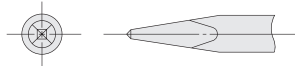

Model	Size	Chisel Shank	Model
	L		
541 205 8742	200	Round	FC-01-4, FC-01SA
541 205 8752	200	Hex	FC-01-3, FC-01SA
541 205 8746	250		
541 205 8715	200	Round	FC-1Z-2, FC-4Z-2
541 205 8710	250		
541 205 8728	200	Hex	FC-1Z-1, FC-4Z-1
541 205 8719	250		

SCALING CHISELS (SL)

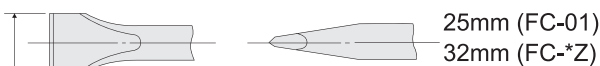

Model	Size	Chisel Shank	Model
	L		
541 205 8743	200	Round	FC-01-4, FC-01SA
541 205 8753	200	Hex	FC-01-3, FC-01SA
541 205 8747	250		
541 205 8716	200	Round	FC-1Z-2, FC-4Z-2
541 205 8711	250		
541 205 8729	200	Hex	FC-1Z-1, FC-4Z-1
541 205 8720	250		

CHISELS HOLDERS (FOE FC - SERIES)



Model		Part Name
FC-01	FC-1Z~4Z	
541 205 4401	541 205 4388	Chisel Holder
541 205 4402	541 205 4389	Retainer Spring

"Different versions available, please check our catalogue or contact Fuji on fujitools.com"

DRILLS AND TAPPERS



Drills



FRD-5S & 6S



FRD-6PH-3



FRD-6PH-7



FRD-8PX

Model	Part number	Drilling Capacity	Stall Torque	Free speed	Spindle	Power	Length	Weight	Air consumption	Inlet	Hose inner diameter
		mm	N.m	rpm	Inch	w	mm	kg	m ³ /min	Inch	mm
FRD-5S-1 E	5412053306	5	2	3,200	3/8-24UNF	180	188	0.6	0.6	Rc 1/4	6.3
FRD-6S-2 E	5412053331	5	2.5	4,300	3/8-24UNF	290	209	0.9	24	Rc 1/4	9.5
FRD-6S-3 E	5412053337	8	2.9	2,800	3/8-24UNF	290	218	1	24	Rc 1/4	9.5
FRD-6S-5 E	5412053343	10	7	1,300	3/8-24UNF	290	237	1.1	24	Rc 1/4	9.5
FRD-6S-7 E	5412053348	13	16	600	1/2-20UNF	290	271	1.7	24	Rc 1/4	9.5
FRD-5P-1 E	5412053302	5	2	3,200	3/8-24UNF	180	155	0.6	0.4	Rc 1/4	6.3
FRD-6PH-2	5412077834	5	2.7	4,300	3/8-24UNF	340	198	0.9	0.58	Rc 1/4	9.5
FRD-6PH-3	5412072186	6.5	3.2	2,800	3/8-24UNF	340	198	0.9	0.58	Rc 1/4	9.5
FRD-6PH-3 8	5412072187	8	3.2	2,800	3/8-24UNF	340	198	0.9	0.58	Rc 1/4	9.5
FRD-6PH-5	5412072188	10	5.5	1,300	3/8-24UNF	320	243	1.4	0.58	Rc 1/4	9.5
FRD-6PH-7	5412072190	13	15.8	600	1/2-20UNF	320	258	1.5	0.58	Rc 1/4	9.5
FRD-8PX-1	5412053363	8	5.9	2,600	3/8-24UNF	440	198	1.7	0.76	Rc 1/4	9.5
FRD-8PX-2	5412053366	10	12	1,300	3/8-24UNF	440	220	2.1	0.76	Rc 1/4	9.5
FRD-8PX-3	5412053368	13	20	900	1/2-20UNF	440	253	2.9	0.76	Rc 1/4	9.5

"Different versions available, please check our catalogue or contact Fuji on fujitools.com"

Corners drills



FCD-6X-1, 2



FCD-10X-1



FCD-6X-1F, 2F



FCD-10X-1F

Model	Part number	Throttle Type	Drilling capacity	Stall Torque	Free speed	Spindle	Power	Overall Length	Weight	Air consumption	Inlet	Hose inner diameter
			mm	N.M	rpm	Inch	w	mm	kg	m ³ /min	Inch	mm
FCD-10X-1 E	541 205 2497	Lever	10	11.8	12,000	3/8-24UNF	420	377	2.2	0.5	Rc 1/4	9.5
FCD-10X-1F E	541 205 2500	Locking Lever (F)	10	11.8	12,000	3/8-24UNF	420	377	2.2	0.5	Rc 1/4	9.5
FCD-6X-1 E	541 205 2534	Lever	6	4.9	25,000	3/8-24UNF	290	267	1.7	0.68	Rc 1/4	9.5
FCD-6X-1F E	541 205 2536	Locking Lever (F)	6	4.9	25,000	3/8-24UNF	290	267	1.7	0.68	Rc 1/4	9.5
FCD-6X-2 E	541 205 2539	Lever	6	7.8	15,000	1/2-20UNF	290	281	1.9	0.68	Rc 1/4	9.5
FCD-6X-2F E	541 205 2541	Locking Lever (F)	6	7.8	15,000	1/2-20UNF	290	281	1.9	0.68	Rc 1/4	9.5

"Different versions available, please check our catalogue or contact Fuji on fujitools.com"

Baby Angle Drills



FCD-6A-1



FCD-6B-1



FCD-6EX-3



FCD-6EX-4

SNAKE DRILLS (SN-2~6)



Thread
1/4-28

DRILLS CHUCKS (CN-1802~1808)



Thread
1/4-28

Snake Drill Bits 2mm to 6mm and Drill Chuck capacities 1/16" to 1/4" are available on request

Model	Part number	Throttle Type	Drilling capacity	Stall Torque	Free speed	Spindle	Power	Overall Length	Weight	Air consumption	Inlet	Hose inner diameter
			mm	N.M	rpm	Inch	w	mm	kg	m ³ /min	Inch	mm
Front Exhaust												
FCD-6A-1 E	541 205 2522	Button	6	2.6	2500	1/4-28UNF	160	223	0.6	0.56	Rc 1/4	6.3
FCD-6B-1 E	541 205 2523	Lever	6	2.6	2500	1/4-28UNF	160	223	0.6	0.56	Rc 1/4	6.3
Rear Exhaust												
FCD-6EX-3	541 205 2527	Button	6	2.6	3500	1/4-28UNF	270	246	0.7	0.69	Rc 1/4	6.3
FCD-6EX-4	541 205 2529	Lever	6	2.6	3500	1/4-28UNF	270	246	0.7	0.69	Rc 1/4	6.3

"Different versions available, please check our catalogue or contact Fuji on fujitools.com"

Heavy duty drills



FRD-20R~32R

Model	Part number	Drilling capacity	Stall Torque	Free speed	Socket	Power	Length	Weight	Air consumption	Inlet	Hose inner diameter
		mm	N.M	rpm	M.T#	w	mm	kg	m ³ /min	Inch	mm
FRD-20R-21	5412053265	19	64	600	2	880	282	7	1.2	Rc 1/2	12.5
FRD-20R-22	5412053269	19	64	600	3	880	307	7	1.2	Rc 1/2	12.5
FRD-23R-21	5412053273	22	19	400	2	880	282	7.3	1.2	Rc 1/2	12.5
FRD-23R-22	5412053277	22	19	400	3	880	307	7.3	1.2	Rc 1/2	12.5
FRD-25R-11	5412053282	25	22	530	3	2100	353	14	3.2	Rc 1/2	19
FRD-28R-11	5412072155	28	25	430	3	2100	353	14	3.2	Rc 1/2	19
FRD-32R-11	5412053290	32	25	380	3	2100	353	14.5	3.2	Rc 1/2	19
FRD-32R-12	5412053294	32	25	380	4	2100	353	14.5	3.2	Rc 1/2	19

"Different versions available, please check our catalogue or contact Fuji on fujitools.com"

Tappers



FT-6BX



FT-8PX

Model	Part number	Tapping capacity	Stall Torque	Free speed	Chuck	Overall Length	Weight	Air consumption	Inlet	Hose inner diameter
		mm	N.M	rpm	Type	mm	kg	m ³ /min	Inch	mm
FT-6BX-1	541 205 3487	8	6	2,000	Jacobs Taper 1	240	1.3	0.56	Rc 1/4	9.5
FT-8PX-1	541 207 2340	10	8	450	MT1	232	2	0.5	Rc 1/4	9.5

"Different versions available, please check our catalogue or contact Fuji on fujitools.com"

ASSEMBLY



Impacts Wrenches



Model	Part number	Recommended Torque Range	Max Torque	Free Speed	Square Drive	Length	Weight	Air consumption	Hose inner diameter
		N.m	N.m	rpm	Inch	mm	kg	m ³ /min	mm
FW-6PH-1	5412053615	24 - 45	50	9,000	3/8	147	1.35	0.35	9.5
FW-10PH-2	5412053533	47 - 79	100	7,500	1/2	179	2	0.45	9.5
FW-14PH-2 E	5412053542	100 - 160	180	7,500	1/2	202	2.56	0.6	9.5
FW-190P	5412104398	240 - 560	620	5,500	3/4	228	5.3	0.7	12.7
FW-330P-1	5412104110	500 - 2100	2,600	5,000	1	283	10.4	1.15	12.7
FW-250-2	5412053558	380 - 1040	1,200	5,000	3/4	302	6	0.7	12.7
FW-330-1	5412104115	500 - 2100	2,600	5,000	1	366	10.7	1.15	12.7
FW-330-1L	5412104120	500 - 2100	2,600	5,000	1	522	12.2	1.15	12.7

"Impacts wrenches are proposed with pin retainer"

"Different versions available, please check our catalogue or contact Fuji on fujitools.com"

Pulse wrenches non-shut off



FL-4 to 5



FLT-6 to 7



FLT-9



FLT-13

Model	Part number	Recommended Torque Range	Output (Square or bit shank)	Free speed	Length	Weight	Air consumption	Hose inner diameter
		N.M	Inch	rpm	mm	kg	m ³ /min	mm
FL-4-3 BF	5412105713	16 - 24	Squ. 3/8	6700	140	0.8	0.4	6.3
FL-4D-3	5412105349	14 - 20	Hex - 1/4	6700	140	0.8	0.4	6.3
FL-5-3 BF	5412105715	20 - 40	Squ. 3/8	6300	140	0.8	0.4	6.3
FL-5D-3	5412105352	18 - 32	Hex - 1/4	6300	140	0.8	0.4	6.3
FL-6-3 BF	5412105717	28 - 56	Squ. 3/8	6700	151	0.8	0.4	9.5
FL-6D-3	5412105355	25 - 42	Hex - 1/4	6700	151	0.8	0.4	9.5
FL-7-3 BF	5412105719	34 - 60	Squ. 3/8	6100	155	1.02	0.6	9.5
FL-9-3 BF	5412105605	52 - 96	Squ. 1/2	5000	173	1.45	0.7	9.5
FL-11-3 BF	5412105616	80 - 136	Squ. 1/2	5000	184	1.8	0.8	9.5
FL-13-3 BF	5412105628	120 - 172	Squ. 1/2	3800	192	2.1	0.9	9.5

"Different versions available, please check our catalogue or contact Fuji on fujitools.com"

Pulse wrenches shut off



FLT-4 to 5



FLT-6 to 7



FLT-9



FLT-13

Model	Part number	Recommended Torque Range	Output (Square or bit shank)	Free speed	Length	Weight	Air consumption	Hose inner diameter
		N.M	Inch	rpm	mm	kg	m ³ /min	mm
FLT-4-3	5412105398	5 - 12	Squ. 3/8	6200	181	0.97	0.4	6.3
FLT-4D-3	5412105399	5 - 12	Hex - 1/4	6200	181	0.97	0.4	6.3
FLT-5-3	5412105401	11 - 24	Squ. 3/8	6500	181	0.97	0.45	6.3
FLT-5D-3	5412105402	11 - 22	Hex - 1/4	6500	181	0.97	0.45	9.5
FLT-6-3	5412105404	22 - 35	Squ. 3/8	6300	193	1	0.55	9.5
FLT-6D-3	5412105405	19 - 28	Hex - 1/4	6300	193	1	0.55	9.5
FLT-7-3	5412105407	30 - 50	Squ. 3/8	6100	190	1.1	0.6	9.5
FLT-9-3	5412105637	45 - 85	Squ. 1/2	5300	209	1.6	0.68	9.5
FLT-11-3	5412105663	70 - 120	Squ. 1/2	5000	217	1.85	0.8	9.5
FLT-13-3	5412105674	110 - 150	Squ. 1/2	3400	227	2.1	0.85	9.5

"Different versions available, please check our catalogue or contact Fuji on fujitools.com"

SPECIAL TOOLS

Pipe Beveling



FBM-16



FBM-24



FBM-80



FBM-300

Model	Part number	Capacity (Pipe Inside Dia.)	Stall Torque	Free speed	Feed Length	Length	Weight	Air consumption	Hose inner diameter
		mm	N.M	rpm	mm	mm	kg	m ³ /min	mm
FBM-16-1	5412052419	12 - 16	25	290	20	261	2.6	0.4	8
FBM-24-1	5412052423	14 - 24	34	180	30	278	2.9	0.4	8
FBM-80A-3	5412052447	40 - 80	113	100	30	403	6.7	0.6	8
FBM-80A-6	5412052459	20 - 80	113	100	30	403	6.7	0.6	8
FBM-300-2	5412052427	80 - 120	431	75	60	603	26.8	1.68	12.7
FBM-300-4	5412052435	80 - 240	431	75	60	603	26.8	1.68	9.5

"Different versions available, please check our catalogue or contact Fuji on fujitools.com"

Air saw



FRS-45

Model	Part number	Stroke per Min.	Stroke	Chuck Capacity	Length	Weight	Air consumption	Hose inner diameter
		SPM	mm	mm	mm	kg	m ³ /min	mm
FRS-45	5412053402	1200	45	2.5X17.7X31	421	2.9	0.4	8

"Different versions available, please check our catalogue or contact Fuji on fujitools.com"

SAW BLADES FOR FRS-45



Item n°	Part number	Size (mm)		Cutting Materials
		L	W	
SAW-2014	5412056216	200	14	Steel plate, pipe, copper, brass, plastic, slate
SAW-2018	5412056217	200	18	Steel plate, pipe
SAW-2024	5412056218	200	24	Steel plate, pipe
SAW-2514	5412056219	250	14	Steel plate, pipe, copper, brass, plastic, slate
SAW-2518	5412056220	250	18	Steel plate, pipe
SAW-3014	5412056221	300	14	Steel plate, pipe, copper, brass, plastic, slate
SAW-3018	5412056222	300	18	Steel plate, pipe

"Different versions available, please check our catalogue or contact Fuji on fujitools.com"

Milling machine



FRC-200-1



FRC-200S-1

Model	Part number	For material	Cutting Capacity	Grooving Capacity	Power	Free Speed	Length	Weight	Air Consumption	Hose inner diameter
			LxW (mm)	mm	w	rpm	mm	kg	m ³ /min	mm
FRC-200	5412053245	Aluminum	50 X 5	15.5	1250	7200	295	4.7	1.4	12.7
FRC-200S	5412106131	Steel	20 X 3	0	1000	4200	295	6.3	1	12.7

"Different versions available, please check our catalogue or contact Fuji on fujitools.com"



Productivity

- Cleans and removes weld seams up to 3 times faster than typical grinding.
- Can cut up to 3mm welding seam.

Clean work

- Roller guides ensure that only the seam is removed.
- Cutting depth setup with large button and scale for precise work

Easy

- Large handles for controlled movement of the tool. Natural handling position even while working on the floor.



AIR MOTORS

Air motor - REVERSIBLE TYPE



F-5SM-8.5R



F-5SM-2R



F-6SM-2.5R~28R



F-8SM-12R~28R



F-8SM-8.5R

Model	Part number	Stall Torque	Power	Free speed	Length	Weight	Air consumption	Inlet	Hose inner diameter
		N.M	w	rpm	mm	kg	m ³ /min	Inch	mm
Chord type spindle									
F-5SM-2R	541 205 2125	21.6	100	190	182	0.8	0.3	PT 1/8	6.3
F-5SM-8.5R	541 205 2130	5.4	120	850	147	0.6	0.3	PT 1/8	8
F-6SM-2.5R	541 205 2158	26	210	250	192	1.2	0.3	PT 1/8	8
F-6SM-5R	541 205 2173	14.7	230	500	179	1	0.3	PT 1/8	8
F-6SM-8R	541 205 2178	9.8	230	750	179	1	0.5	PT 1/8	8
F-6SM-12R	541 205 2153	5.9	230	1000	157	0.8	0.3	PT 1/8	8
F-6SM-21R	541 205 2163	4	260	2000	146	0.9	0.3	PT 1/8	8
F-6SM-28R	541 205 2168	3.3	250	2300	146	0.8	0.3	PT 1/8	8
Key type spindle									
F-8SM-8.5R	541 205 2222	14.7	370	850	222	1.5	0.3	PT 1/4	9.5
F-8SM-12R	541 205 2218	9.8	370	1100	199	2.2	0.5	PT 1/4	9.5
F-8SM-28R	541 205 2220	6.4	380	2300	183	1.5	0.5	PT 1/4	9.5
Thread type spindle									
F-8SM-8.5R	541 205 9075	14.7	370	850	222	1.5	0.3	PT 1/4	9.5

"Different versions available, please check our catalogue or contact Fuji on fujitools.com"

Chord Type	Key Type	Thread Type
		3/8-24(UNF) 1/2-20(UNF) for F-8SMA-8, 5

Air motor - NON-REVERSIBLE TYPE



F-5SM-8.5



F-6SM-2.5~28



F-5SM-2



F-8SMA-8.5~28

Model	Part number	Stall Torque	Power	Free speed	Length	Weight	Air consumption	Inlet	Hose inner diameter
		N.M	w	rpm					
Chord type spindle									
F-5SM-2	541 205 2122	23.5	120	200	187	0.9	0.3	PT 1/8	6.3
F-5SM-8.5	541 205 2127	5.9	130	950	153	0.6	0.3	PT 1/8	6.3
F-6SM-2.5	541 205 2155	28.4	260	300	213	1.2	0.3	PT 1/8	9.5
F-6SM-5	541 205 2170	15.7	250	600	200	1	0.3	PT 1/8	9.5
F-6SM-8	541 205 2175	10.8	260	900	200	1	0.5	PT 1/8	9.5
F-6SM-12	541 205 2150	7.4	290	1300	181	0.9	0.3	PT 1/8	9.5
F-6SM-21	541 205 2160	4.4	290	1400	167	0.8	0.3	PT 1/8	9.5
F-6SM-28	541 205 2165	3.9	290	2800	167	0.8	0.3	PT 1/8	9.5
Key type spindle									
F-8SM-8.5	541 205 2230	16.7	440	900	208	2.2	0.5	PT 1/4	9.5
F-8SM-12	541 205 2224	11.8	440	1300	200	2	0.3	PT 1/4	9.5
F-8SM-28	541 205 2227	5.9	440	2600	171	1.5	0.5	PT 1/4	9.5
Thread type spindle									
F-6SM-12	541 205 2152	7.4	290	1300	181	0.9	0.3	PT 1/8	9.5
F-8SMA-8.5	541 205 2232	16.7	440	900	208	2.2	0.5	PT 1/4	9.5
F-8SMA-12	541 205 2226	11.8	440	1300	200	2	0.3	PT 1/4	9.5
F-8SMA-28	541 205 2229	5.9	440	2600	171	1.5	0.5	PT 1/4	9.5

"Different versions available, please check our catalogue or contact Fuji on fujitools.com"

Air line accessories

Air Tool Oil



AC No.	Part No.
AO-120	5412050886

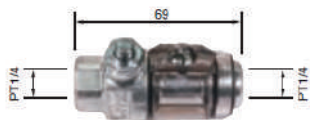

AC No.	Part No.
MO-02	5412054842

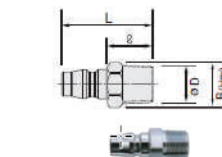

AC No.	Part No.	Size			
		D in	L mm	I mm	B(Hex) mm
M-627	5412054828	PT 1/4	40	20.0	14
M-628	5412054829	PT 3/8	40	20.0	17
M-629	5412054830	PT 1/2	46	26.0	21

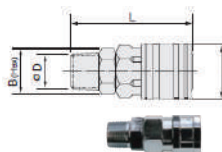

AC No.	Part No.	Size			
		D in	L mm	I mm	B(Hex) mm
M-526	5412054817	PT 3/8	25	56.5	19
M-527	5412054818	PT 1/2	25	58.5	21

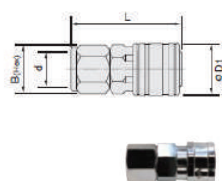

AC No.	Part No.	Size			
		D in	L mm	I mm	B(Hex) mm
M-528	5412054819	PT 1/4	25	50.5	19
M-529	5412054820	PT 3/8	25	52.5	21
M-530	5412054821	PT 1/2	25	54.5	26

"Different versions available, please check our catalogue or contact Fuji on fujitools.com"



Fuji is a leading Japanese manufacturer in the pneumatic tools industry. Since 1943, we are committed to improve our customers' productivity worldwide and to provide one of the most extensive ranges of high-quality and robust industrial air tools.

To learn more, visit www.fujitools.com.

Fuji Authorized Distributor:



www.fujitools.com